

ACCESS CORRIDOR
2 BEDROOM 61 SQ.M.
PLUS BALCONY PLUS COURT YARD AND STORE

20 NO. TYPE F7

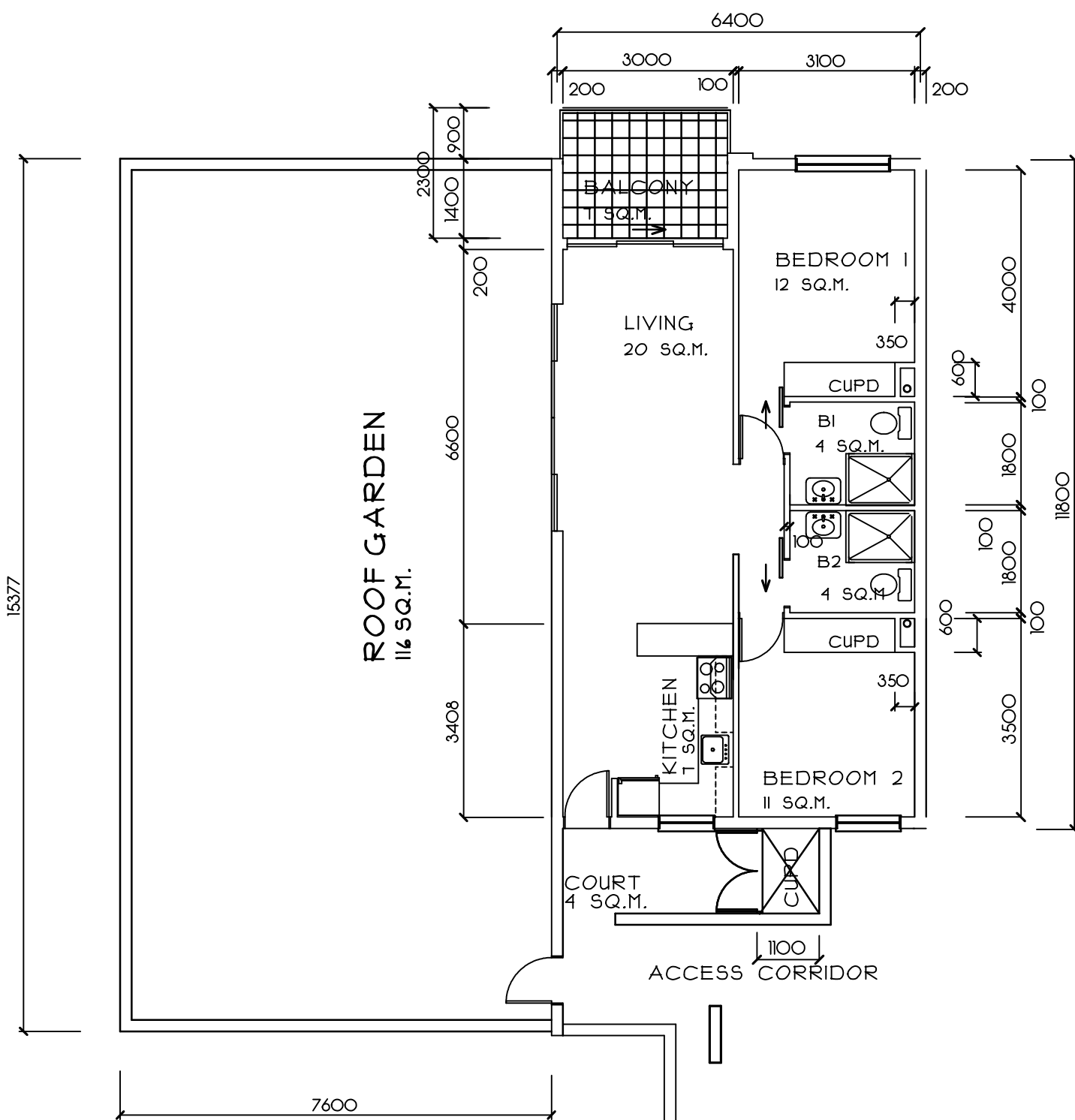

2 BEDROOM 71 SQ.M.
PLUS BALCONY PLUS COURT YARD, STORE
AND ROOF GARDEN

1 NO. TYPE F5

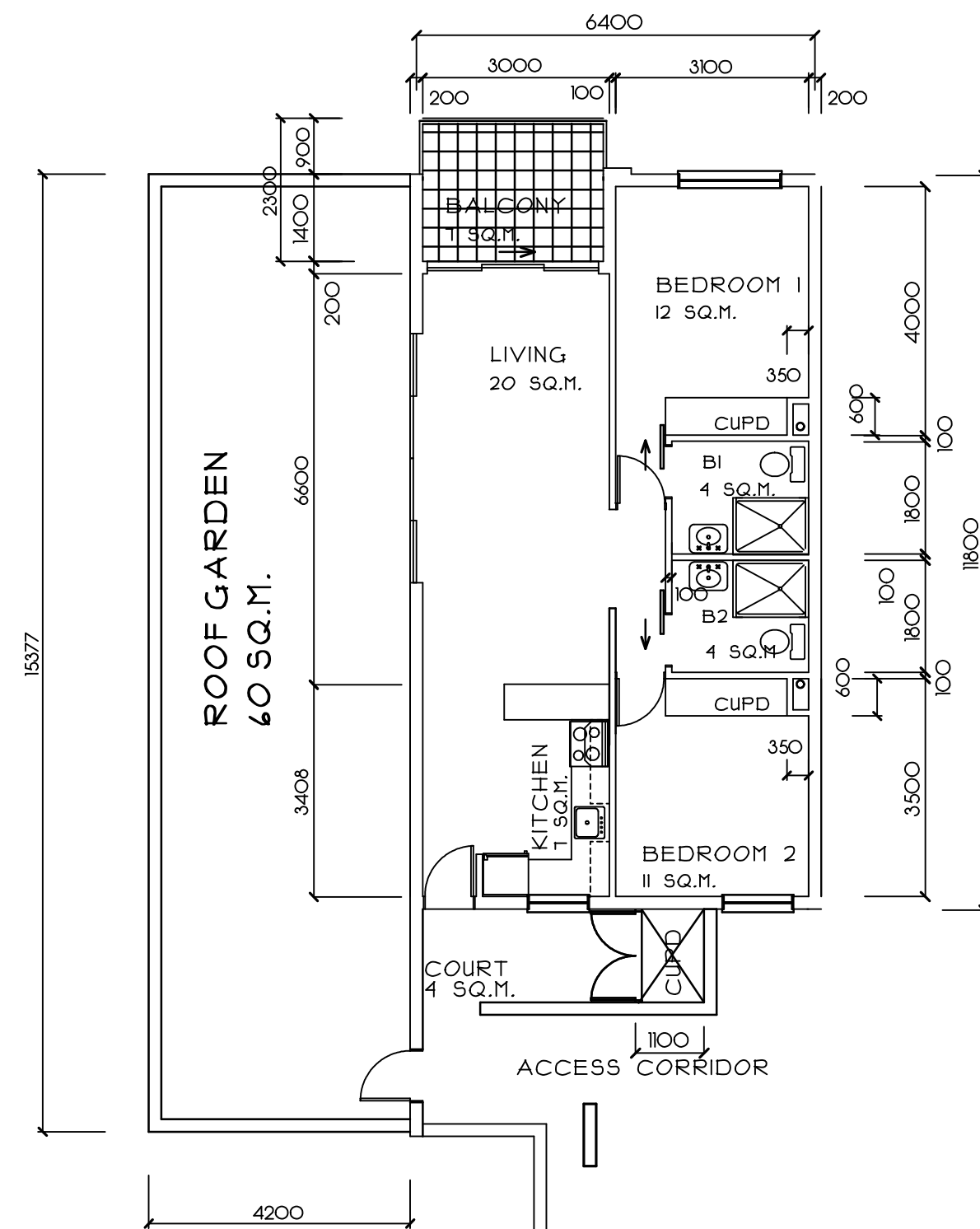

2 BEDROOM 71 SQ.M.
PLUS BALCONY PLUS COURT YARD, STORE
AND ROOF GARDEN

1 NO. TYPE F6

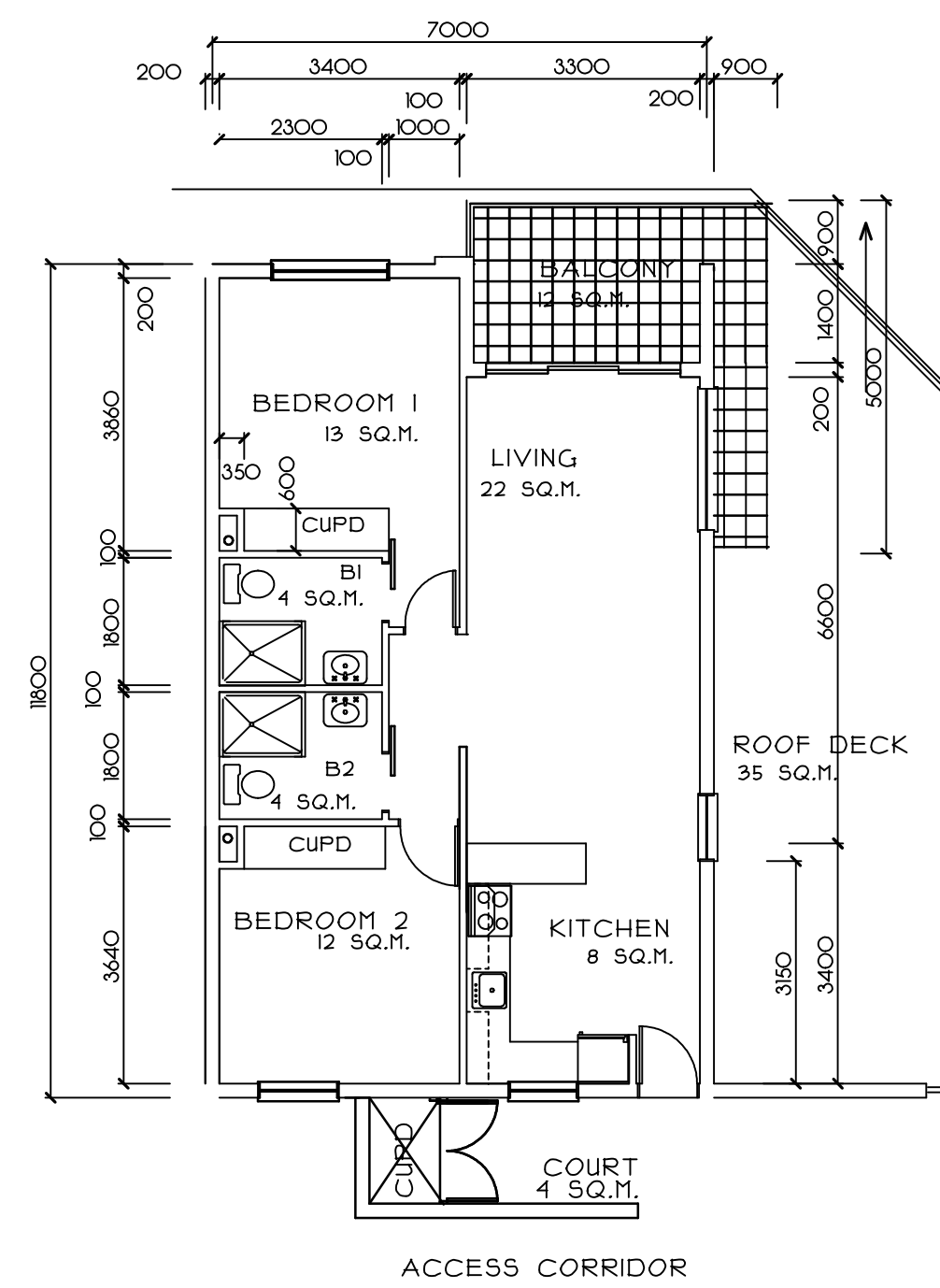

2 BEDROOM 78 SQ.M.
PLUS BALCONY PLUS COURT YARD AND STORE

1 NO. TYPE B2

REVISIONS		
NO	DATE	DESCRIPTION
CLIENT		
ARCHITECT		
REG. NO. 6580		

OVERFLOW
Design
ARCHITECTS. CC

REGISTRATION NO. GK 1989/020861/23
CORPORATE MEMBER OF THE SOUTH AFRICAN INSTITUTE OF ARCHITECTS
BARRY L. UPTON
DIP.ARCH.(ICS) DIP.PM.(EE) Pr. Arch. MArch. KZ-NIA. M.S.A.I.B.D.
11, STARLING PLACE GILLITTS 3610
PH (031) 7672029 FAX TO EMAIL 086 7703510
cell 0837757562 Email overflow@iafrica.com
www.overflowdesign.blogspot.com

PROJECT
NEW APARTMENTS ON
AURORA DRIVE, SUMMER WAY &
UMHLANGA RIDGE BOULEVARD
FOR
DEXAPHASE (PTY) LTD
LOTS 96.,97.,98.,99.,104.,105 & 106
PRECINCT 9A UMHLANGA

DRAWING
SKETCHES
DETAIL UNIT PLANS

DATE	NOVEMBER 2015
SCALE	1 : 100
DRAWN	BARRY UPTON
DRAWING NUMBER	019
COMP.REF.NO.	REKESHumhlanga