

U M H L A N G A
R I D G E
B O U L E V A R D

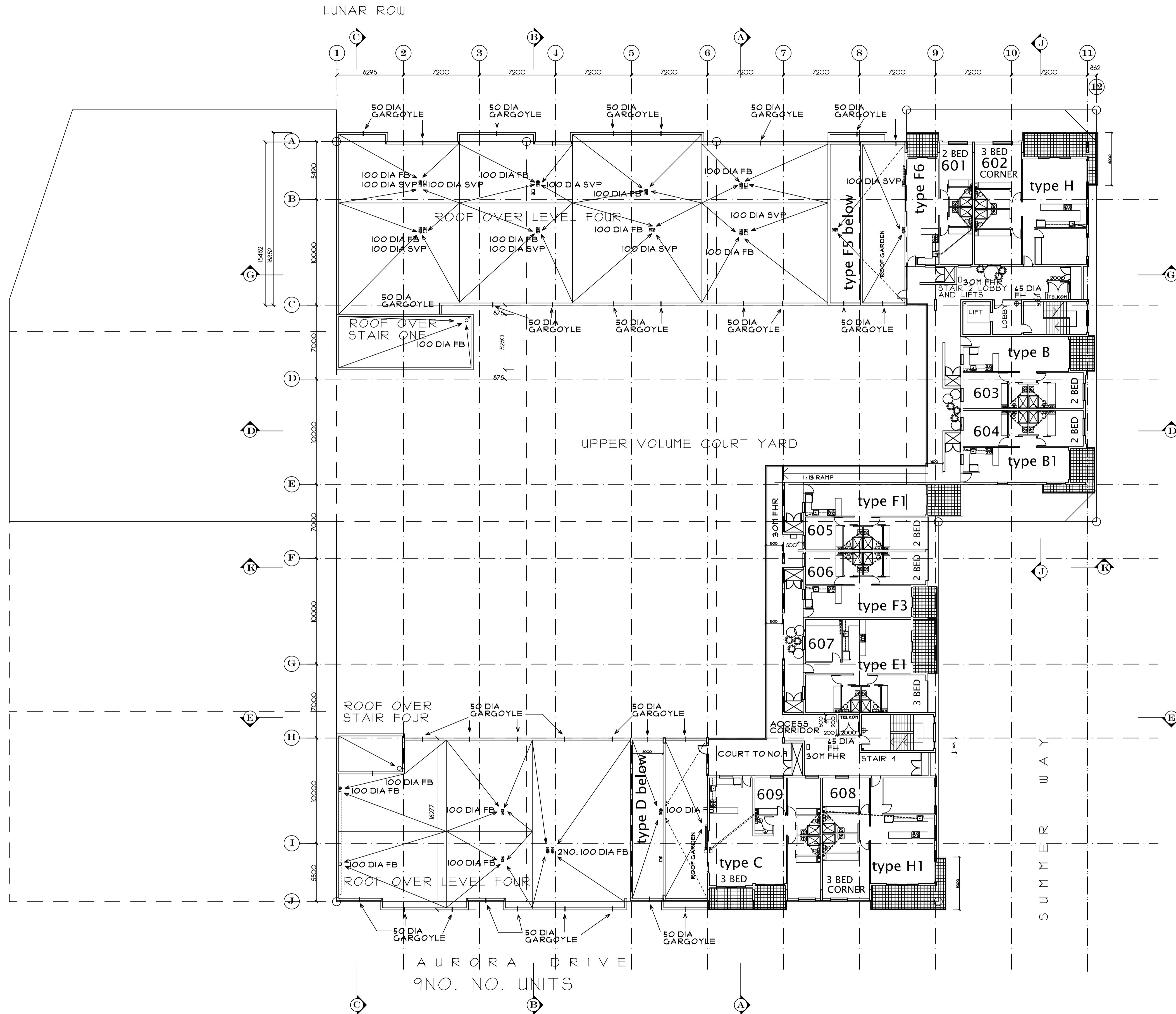

6TH FLOOR PLAN

AURORA DRIVE
9NO. NO. UNITS

READ IN CONJUNCTION WITH DWG. NO. 001
O1B., and O19. FOR DETAILED UNIT LAYOUTS
ALL DRAWINGS AND DETAILS WILL
COMPLY WITH SANS 10400

| REVISIONS | | |
|--|------|-------------|
| NO | DATE | DESCRIPTION |
| 20TH OCTOBER 2016 - REVISIONS REMOVED AND DRAWINGS ISSUED FOR CONSTRUCTION | | |
| CLIENT | | |
| ARCHITECT REG. NO. 6580 | | |

OVERFLOW
Design
ARCHITECTS. cc
REGISTRATION NO. CK 1989/020881/23
CORPORATE MEMBER OF THE SOUTH AFRICAN INSTITUTE OF ARCHITECTS

BARRY L UPTON
DIP.ARCH.(ICS) DIP.PM.(EE) Pr. Arch. MArch. KZ-NIA. M.S.A.I.B.D.
11, STARLING PLACE GILLITTS 3610
PH (031) 7672029 FAX TO EMAIL 086 7703510
cell 0837757562 Email overflow@iafrica.com
www.overflowdesign.blogspot.com

PROJECT
LE BOULEVARD
NEW APARTMENTS AT
6, LUNAR ROW, UMLHANGA ROCKS
FOR
DEXAPHASE (PTY) LTD
PORTION 114 OF ERF 2426
UMLHANGA ROCKS

| | |
|--|---|
| DRAWING SUBMISSION DRAWING TYPICAL STOREY UNITS 5TH., AND 6TH STOREYS | |
| DATE SCALE DRAWN | DECEMBER 2015 1 : 200 BARRY UPTON |
| DRAWING NUMBER | 005 |
| COMP.REF.NO. | REKESHumhlanga |