

UMHLANGA RIDGE BOULEVARD

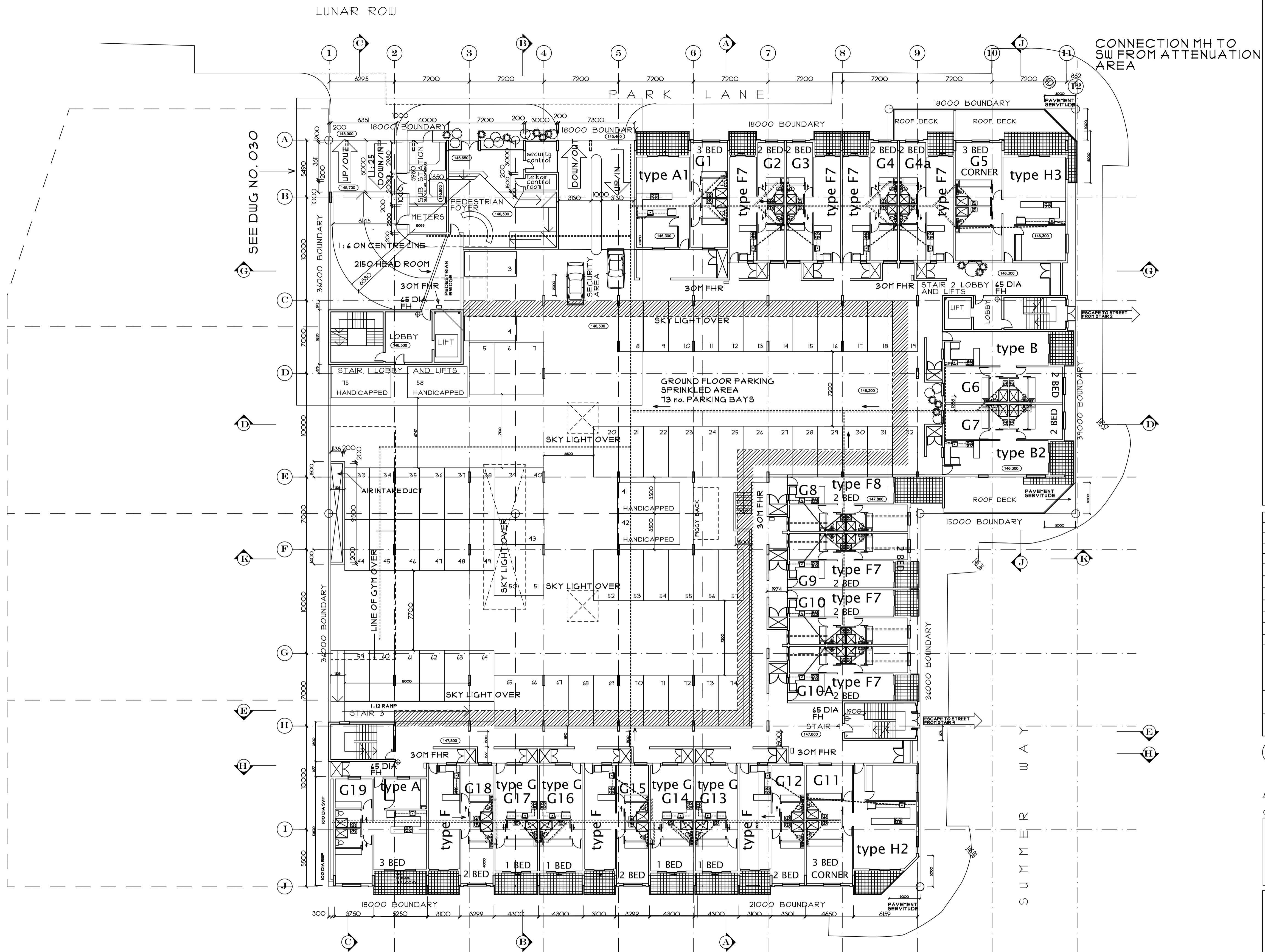

SEE DWG NO. 030

CONNECTION MH TO SW FROM ATTENUATION AREA

READ IN CONJUNCTION WITH DWG. NO. 001, 018., and 019. FOR DETAILED UNIT LAYOUTS ALL DRAWINGS AND DETAILS WILL COMPLY WITH SANS 10400

REVISIONS		
NO	DATE	DESCRIPTION
A	31 OCT 2016	TYPE A OMITTED AND G1 ADDED

20TH OCTOBER 2016 - REVISIONS REMOVED AND DRAWINGS ISSUED FOR CONSTRUCTION

CLIENT
ARCHITECT
REG. NO. 6580

OVERFLOW Design
ARCHITECTS. cc
REGISTRATION NO. CK 1989/020881/23
CORPORATE MEMBER OF THE SOUTH AFRICAN INSTITUTE OF ARCHITECTS

BARRY L. UPTON
DIP.ARCH.(CS) DIP.PM.(EE) Pr. Arch. MArch. KZ-NIA, M.S.A.I.B.D.
11, STARLING PLACE GILLITTS 3610
PH (031) 7672029 FAX TO EMAIL 086 7703510
cell 0837757562 Email overflow@africa.com
www.overflowdesign.blogspot.com

PROJECT
LE BOULEVARD
NEW APARTMENTS AT
6, LUNAR ROW, UMHLANGA ROCKS FOR
DEXAPHASE (PTY) LTD
PORTION 114 OF ERF 2426
UMHLANGA ROCKS

DRAWING
SUBMISSION DRAWING
GROUND STOREY PARKING
19NO. AND UNITS

DATE DRAWN	DECEMBER 2015
SCALE	1 : 200
DRAWN	BARRY UPTON
DRAWING NUMBER	002 A
COMP. REF. NO.	REKESHumhlanga

AURORA DRIVE
21 NO. UNITS
13 PARKING BAYS INC 4 HANDICAPPED AND 1 PIGGY BACK

SEWER AND STORM WATER CONNECTION DETAILS BY ENGINEER

GROUND FLOOR PLAN

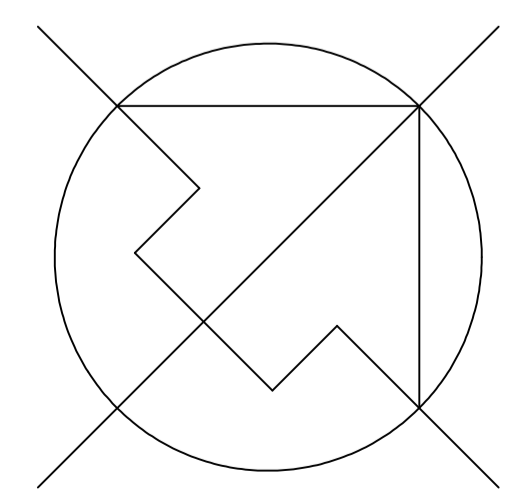

K22